

# RPA CASE STUDY: NEXT GENERATION INVOICE PROCESSING TOOL

Rossum’s Elis and UiPath Robot create an end-to-end solution for invoice automation.

## SITUATION

Our client, a publicly traded beverage producer, was receiving an increasing number of invoices from hundreds of vendors with very different formats. They captured data from all invoices manually and it took one specialist an average of 2 minutes to enter each invoice into SAP, with fluctuating accuracy. As the client processed tens of thousands of invoices, the situation became a strategic and urgent issue that had to be solved. Front-end integration of Rossum’s Elis and UiPath could be deployed in a few days. Integrated by EY.

## SOLUTION

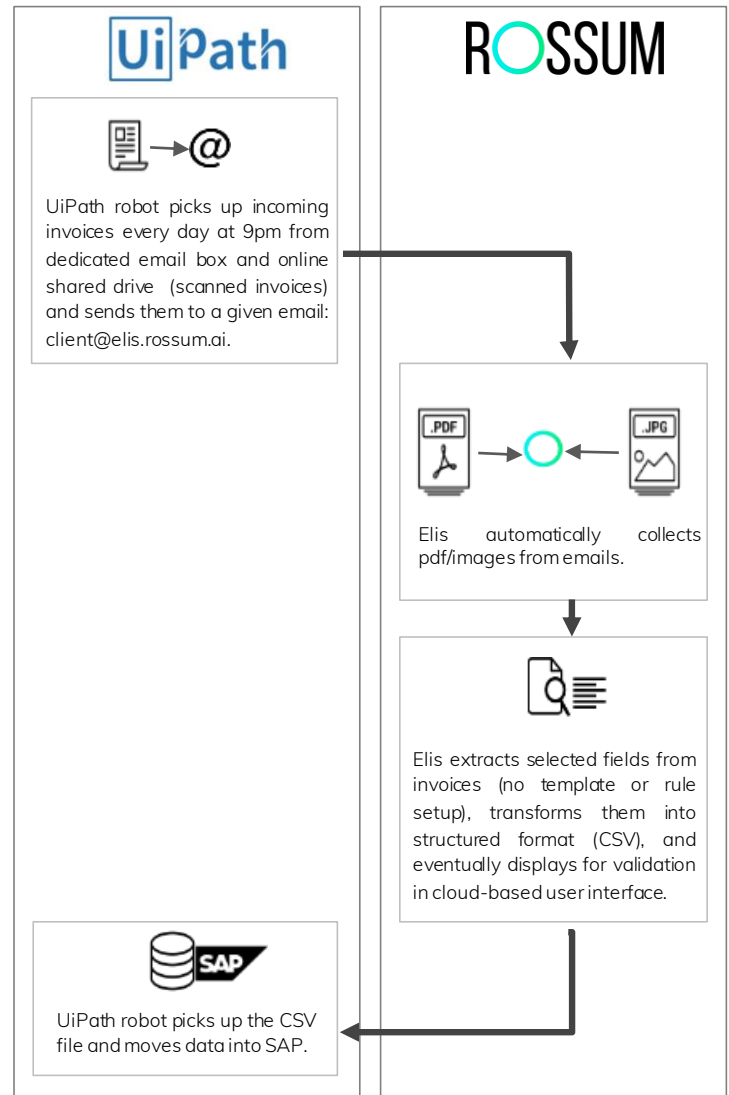

## RESULTS

4  
HOURS

Time to onboard first client  
Rossum + UiPath

0  
HOURS

Time to setup and adjust  
templates

30  
sec.

Elis' time to process one  
invoice